



TECHNICAL & HOSPITALITY
RIDER

Version: 24/11/2024



INDEX

Index _____	2
Input List & Notes _____	3
Wireless _____	4
Stage Plot _____	5
Monitoring Preferences _____	6
Requests & Hospitality _____	7
Contact _____	8

INPUT LIST

CHANNEL	INSTRUMENT	MIC/DI
1	KICK TRIGGER	DI
2	KICK	AUDIX D6
3	SNARE TOP	SHURE SM57
4	SNARE BOTTOM	SHURE SM57
5	HIHAT	NEUMANN KM184
6	TOM 1	AUDIX D2
7	TOM 2	AUDIX D2
8	TOM 3	AUDIX D2
9	TOM 4	AUDIX D6
10	OVERHEAD L	NEUMANN KM184
11	OVERHEAD R	NEUMANN KM184
12	GUITAR AMP L	AXE FX - XLR OUT
13	GUITAR AMP R	AXE FX - XLR OUT
14	BASS AMP	QUAD CORTEX - XLR OUT
15	LEAD VOCALS TIJN	SHURE SLX D24E / BETA 58
16	BACKING VOCALS KEVIN	SHURE SM 58
17	BACKING TRACKS L	DI
18	BACKING TRACKS R	DI

WIRELESS

NO. OF CH	USE	BRAND	MODEL	FREQ. BAND	Mhz. Low	Mhz. High	Frequency
1	MIC	SHURE	SLXD24E	K59	606,000	650,000	606,975
1	INST	SHURE	GLXD16	Z2	2404,000	2478,000	2411 2413 2424 2425 2442 2443 2462 2464
1	INST	SHURE	GLXD16	Z2	2404,000	2478,000	2418 2419 2430 2431 2448 2450 2469 2471
1	INST	SHURE	GLXD16	Z2	2404,000	2478,000	2405 2406 2436 2437 2455 2457 2476 2477

We are a loud band so a PA system with enough power is strongly advised.

The input list above is based on an ideal situation, where the venue and FOH desk are sufficient enough to realize this.

In smaller venues/bars with a smaller PA and FOH desk all 16 channels are not a necessity.

The microphones are put there as an indication, any quality mic comparable to the one mentioned on the input list will suffice.

We're using a Cymatic LP16 to send **backing tracks** to the FOH system and also provide in ear metronome monitoring for Martijn (drummer)

For convenience we built a rack with a **Stereo DI** and 1 **Mono DI** for **Kick Trigger**.

This means that the venue/organizer providing the DI's is optional, however if this is preferred we will work with the DI's provided by the venue/rental company.

Both digital guitar amps (2x Axe FX Ultra) will have two outputs:

- 1) DI Out – Send to FOH
 - 2) Jack output – Send to onstage cabinets.
- No need to mic up the guitar cabinets.

STAGE PLOT

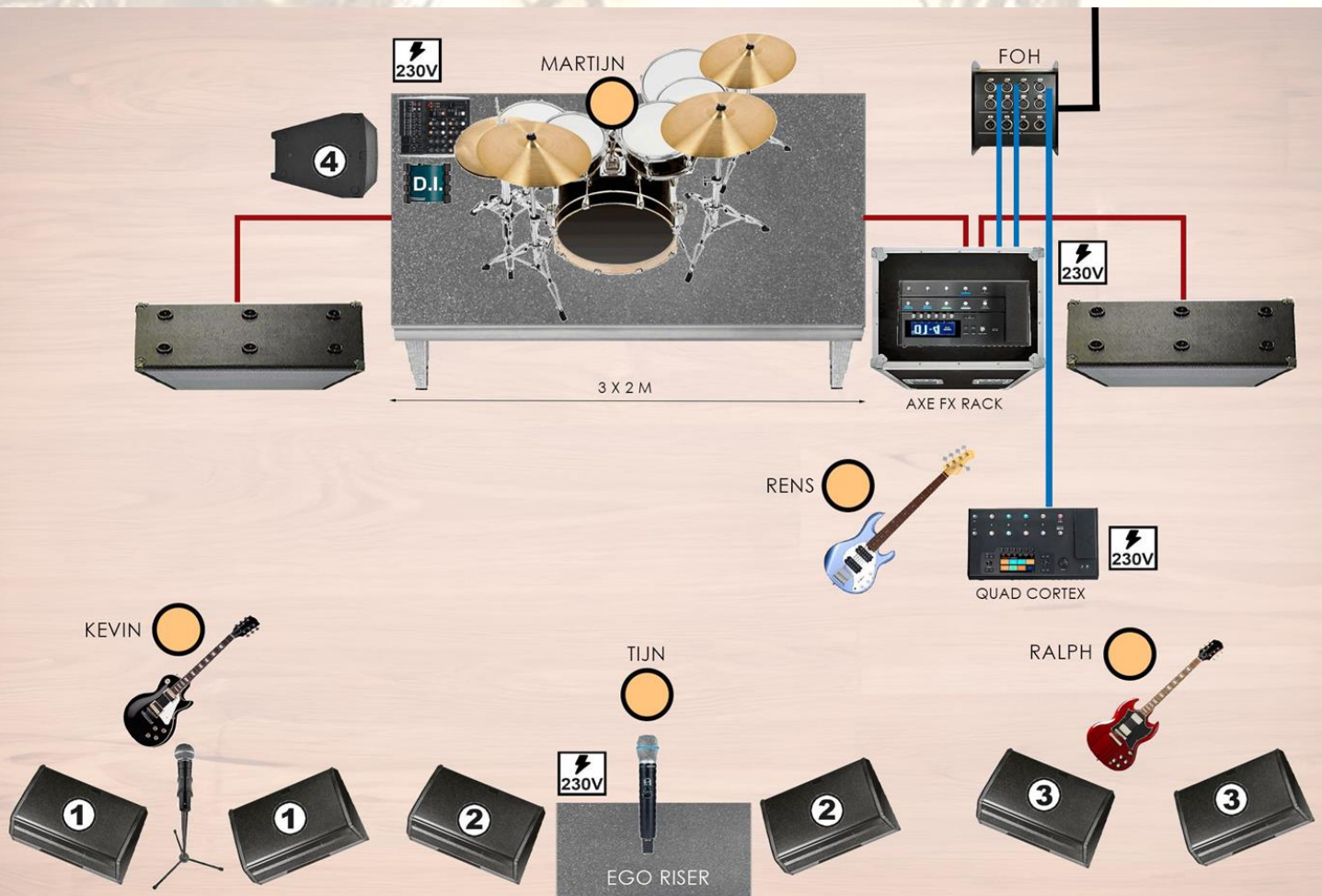

IMPORTANT INFO

- Kevin (Guitarist & Backing vocal) needs a Mic Stand.
- Tijn (Lead vocals) doesn't need a Mic stand.
- Martijn (Drummer) is left-handed!

Normally we will bring along drum hardware and set up cymbals backstage to keep change-over time at a minimum, unless agreed upon differently with the touring party

MONITOR PREFERENCES

Please read carefully this will make our line-check/soundcheck more fluent and swiftly.

All preferences are put into scale of 1 to 5, in which 1 indicates low and 5 high volume. This determines the importance of signal volume for each member/monitor and how loud each signal needs to be compared to others.

Signal	Kevin (Guitar SR & backing vocals)	TIJN (Vocals)	Ralph (GUITAR SL)	Martijn (DRUMS)
	GROUP 1	GROUP 2	GROUP 3	GROUP 4
Kick Trigger	****	****	****	*
Snare & toms				
Guitar SR	****		**	****
Guitar SL			****	
Bass				
Vocals	*	****	*	
Backing Vocals	****			
Backing Track	*	*	*	

HOSPITALITY & REQUESTS

Parking:

If possible we would like to have the **minimum of 3 parking places** available on the terrain of the **venue/festival terrain**. Preferably near the **loading dock**, this will make the **load in/load out** a lot more fluent and less time consuming

Travel Party:

9 persons (band: 5 and crew: 4).

If there are any changes in this amount, we will inform you asap. It might be that we don't bring (all) crew due to (private) schedule overlap.

Storage for instruments:

We would like to have a **storage/safe place** to be able to safely store our instruments. This also means we have to be able to quickly and easily get our gear when needed.

Backstage:

We would like to have a set of **towels** (min. 1 per member), for after the show.

Beverages and food that we request backstage

- **Bottles of water (during show)**
- **Coca Cola/Sprite/Dr Pepper/Fanta etc..**
- **Beer (after-show)**
- **4-6 bottles of alcohol-free beer**
- **2 cans of Red Bull**
- **Water Boiler & tea choices**
- **Piece of ginger & some honey**
- **Min. 2 bananas**

Food:

If our get in time is before **17:00** we expect a warm meal or a payout (€15,- per person) to get food locally. This buy-out will be added to the fee.

Allergies & diets:

Lactose (1 pers.) The same person also doesn't prefer to eat chicken.

The band or crew doesn't follow any diets.

Stage:

Each member will need at least **2 bottles of still water** ready at their spot on the stage.

Merch:

The organization will provide a spot where merchandise can be sold and our merchandise can be showcased properly.

Organization will also provide a sturdy table **including a power strip**.

CONTACT

For any questions and unclear information please reach out to us through E-mail or the phone numbers written down below.

WEBSITE:

www.nephylim.nl

EMAIL:

info@nephylim.nl

PHONE:

Ralph Lentink	+31 6 41 38 41 11	(Hospitality & Band representative)
Martijn Paauwe	+31 6 57 55 24 28	(Technical)